

*Introducing  
the all new...*

# ROADSTER 12

Disc brake  
adjustment Instructions

**TRIKKE™**

# PLEASE READ THIS FIRST

Although this Instruction is intended for FULL brake adjustment which includes the alignment of the caliper, FIRST try adjusting only the brake pads following steps 10 through 15.

Now the T12 comes with the caliper pre-aligned so, in most cases, there is no need for following the full procedure.

If the brakes are not working perfectly after following steps 10 -15, return to the beginning of the Instructions for aligning the caliper; follow the instructions to the end.

# **TRIKKE™** 12 **ROADSTER**

## ***Disc brake adjustment Instructions***

The disc brake system on the Trikke 12 Roadster offers a whole new world of control, precision and durability to the Trikke riding experience.

Disc brakes require a precise setup procedure to insure proper function. Due to the flexible nature of bicycle size brake discs certain adjustments might have to be made several times before the operation of the brakes is optimized.

These adjustments are typically done by qualified bicycle mechanics, so if you feel as though you do not have the skill to properly execute these instructions, please have your local bike shop do the setup for you.

Final note: To properly adjust the brakes you should purchase a set of long metric allen wrenches as seen in the photo to the right. Though your T12 comes with a set of wrenches for handlebar and wheel attachment, these extra wrenches are necessary for brake adjustment and maintenance. They can be purchased at any hardware store.



*Tools needed:*  
*Allen wrenches*  
*& pair of pliers*

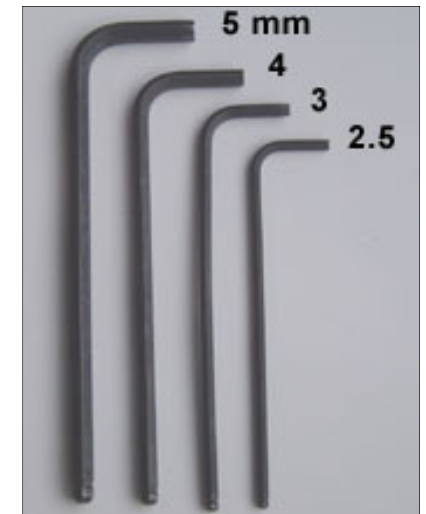

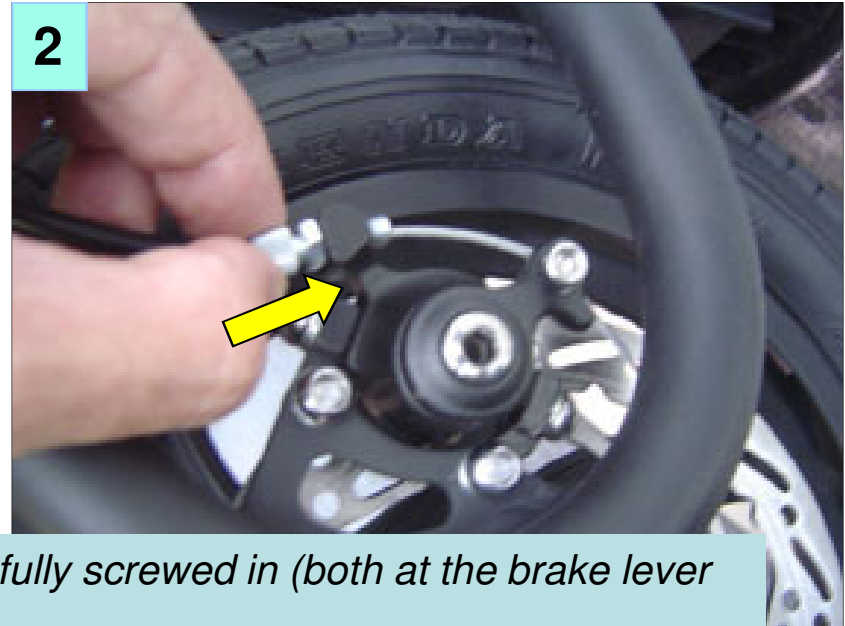
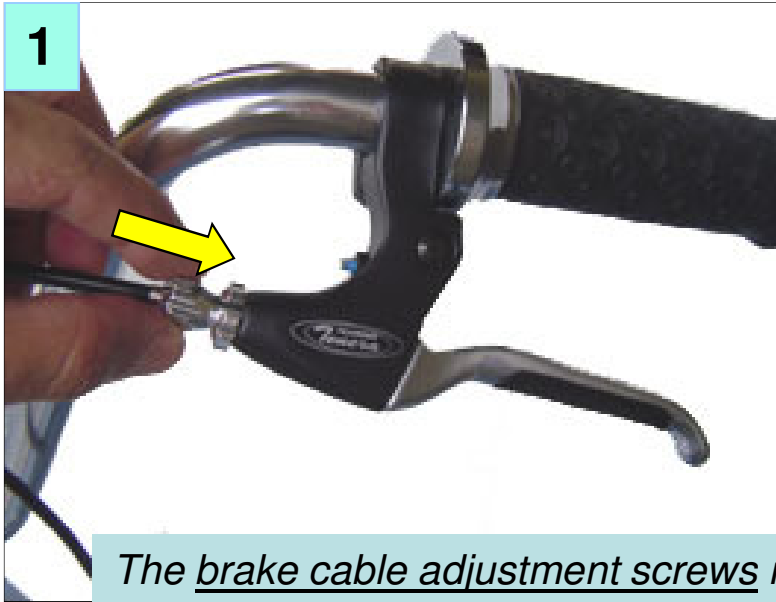

The brake cable adjustment screws must be fully screwed in (both at the brake lever on the handlebar and at the brake caliper).

The caliper lever (1) must be in its fully open position (clockwise). If the cable tension prevents the lever from resting in its fully open position, loosen the cable stay (2), hold the lever open (3), and hold the cable taut with pliers before retightening the stay.

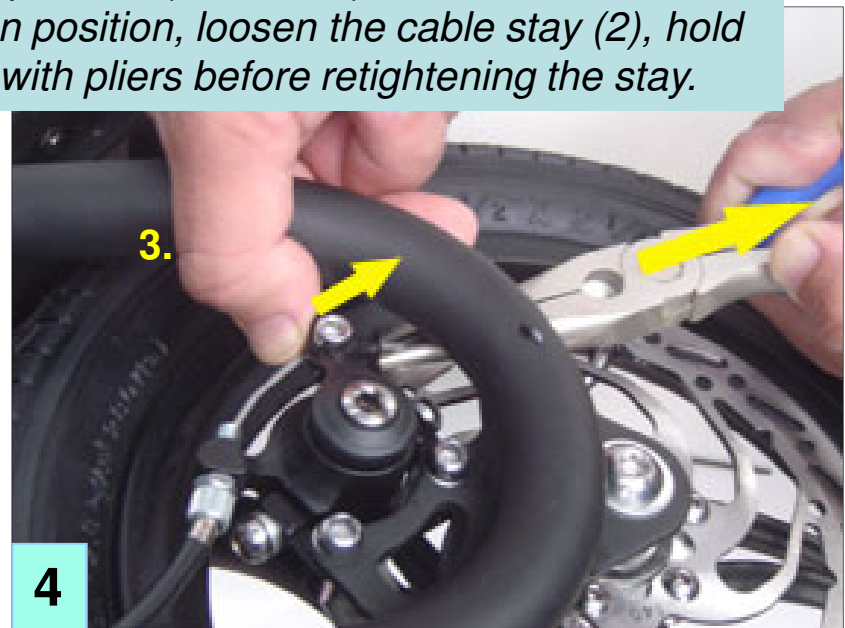
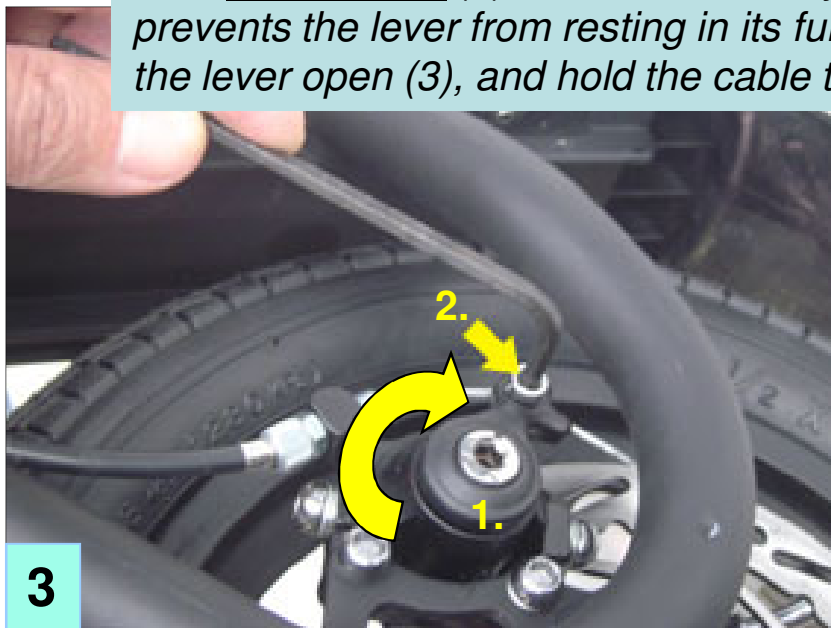

Make sure the two bolts that connect both calipers to the frame are tight.



Loosen the 2 lateral bolts that connect the caliper to its bracket (not to the trikke frame), using a 5mm allen wrench. Loosen them well...



Using a 3mm allen wrench, back the outer pad away from the disc until it stops.  
**Note:** pass the 3mm wrench through the outer 5mm hole to reach the 3mm bolt.  
Now, screw it back towards the disc with one full rotation of the wrench.

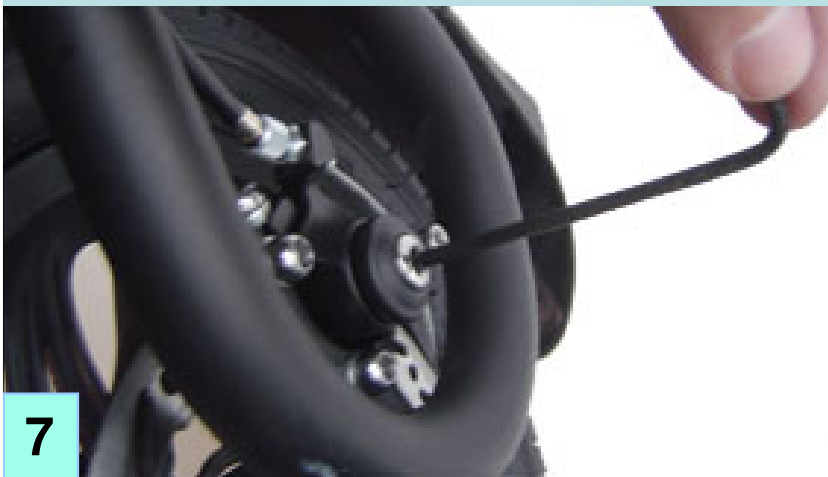

Using a 5mm allen wrench, tight the inner pad against the disc until the disc is locked. You should not be able to rotate the wheel.



Re-tightening the lateral caliper bracket bolts by alternating several times from bolt to bolt. Don't tighten one then the other.



**9** The result is the caliper & disc are perfectly aligned ...very important.

Back off the inner pad until it doesn't touch the disc. A light rub is ok.



**10**

Back off the outer pad until it doesn't touch the disc. A light rub is ok.



**11**

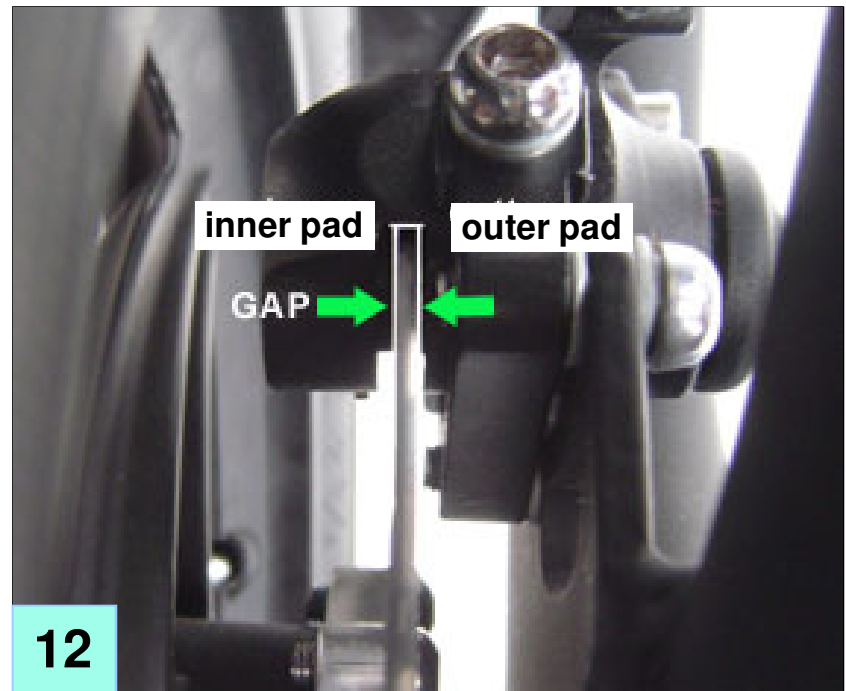

**12**

*Spin each wheel. If the disc wobbles when rotated, mark the extreme point of the disc that is off and correct it by using your fingers to bend the disc in or out. Repeat this correction until the disc is "true" or no longer shows any wobble when you spin it. (this is a common procedure because bicycle discs are very thin and may get deformed easily).*

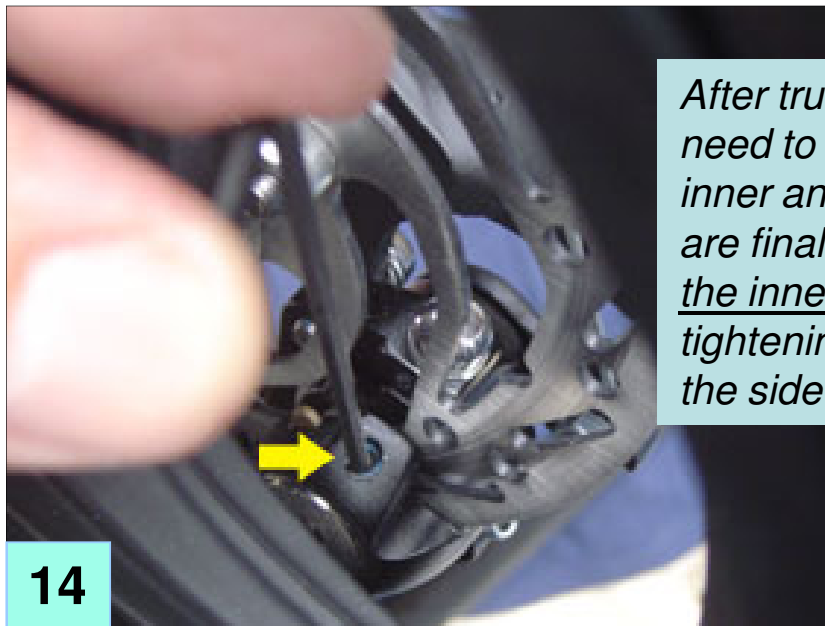

*After trueing the discs in step 13, you might need to make minor adjustments to the inner and outer pads. When adjustments are final, use a 2.5mm allen wrench to lock the inner pad adjustment screw by tightening its locking bolt ( a small bolt at the side of the inner pad body)*



After some use, the brake pads will wear down a bit and seat properly with the disc. Also, the brake cable will stretch. Re-adjust your brakes using the fine adjustment screws at the brake lever and at the caliper as seen in steps 1 & 2.

For additional information about the Trikke T12 Roadster, to troubleshoot brake setup issues, or to learn about other Trikke products and accessories, visit us at [www.trikke.com](http://www.trikke.com) or call (310) 306-8882.